

# Exhibit A

Page 1 of 2

## Parcel Description

That City of Lafayette parcel described in Order vacating Rule and Order and for Immediate Possession filed July 30, 1991 at Reception Number 1119858 and also described in Rule and Order filed August 23, 1993 at Reception Number 1328765; Together with a portion of that parcel Quit Claimed to the City of Lafayette filed September 2, 2020 at Reception Number 3812518; and Together with a portion of County Road 148 (901) all being a portion of the south half of the southeast quarter of Section 36, Township 1 North, Range 69 West of the Sixth Principal Meridian, Boulder County, Colorado, more particularly described as follows:

### Note:

1. Basis of Bearings is the south line of the southeast quarter of Section 36 as monumented with an aluminum cap PLS 4846 as a witness corner which bears N 00°20'06" W a distance of 74.00' feet from the true corner position at the west end and an aluminum cap PLS 14083 at the east end with a grid bearing of N 89°36'21" E..
2. All directions, distances and dimensions are based on coordinates from the Colorado coordinate system of 1983 North zone (C.R.S. 38-52-102).

Commencing at the southeast corner of the southeast quarter of Section 36, an aluminum cap PLS 14083; Thence S 89°36'21" W, along the south line of said southeast quarter, a distance of 1421.10 feet, more or less, to the centerline of that tract described in Quit Claim Deed to Burlington Northern Inc. filed September 26, 1977 at Reception Number 243865; Thence N 26°14'21" E, along said centerline, a distance of 139.92 feet, more or less, to a point on the northerly right of way line of State Highway 7 as described in that Special Warranty Deed to The Department of Highways, State of Colorado filed June 17, 1964 at Reception Number 758560, said point also being a point on the northerly line of that parcel annexed to the City of Lafayette by Ordinance No. 35, Series 1988 filed December 27, 1988 at Reception Number 959468 and the POINT OF BEGINNING.

Thence S 89°36'21" W, along said northerly right of way line as extended, a distance of 34.33 feet, more or less, to a point on the easterly line of that parcel Quit Claimed to Thao T. Nguyen filed November 24, 2010 at Reception Number 3115964, said point also being on the westerly right of way line of County Road 148 (901); Thence N 26°47'26" E, along said easterly line, a distance of 752.50 feet, more or less, to a point on the southerly line of said parcel described at Reception Numbers 1119858 and 1328765; Thence N 63°12'47" W, along said southerly line, a distance of 328.34 feet, more or less, to a point on the boundary line of that parcel annexed to the Town of Erie by Ordinance No. 33 Series 2016 filed February 3, 2017 at Reception Number 3573282; Thence N 26°47'29" E, along said boundary line, a distance of 342.59 feet; Thence N 89°36'29" E, continuing along said boundary line as extended, a distance of 446.24 feet, more or less, to a point on the easterly line of Tract AC, Parkdale Filing No. 1 filed September 17, 2020 at Reception Number 3816093; Thence N 26°13'11" E, along said easterly line, a distance of 81.54 feet, more or less, to a point on the north line of the south half of the southeast quarter of said Section 36; Thence N 89°44'17" E, along said northerly line, a distance of 42.68 feet, more or less, to a point on the westerly line of that parcel annexed to the City of Lafayette by Ordinance No. 33 Series 1988 filed December 27, 1988 at Reception Number 959463; Thence S 26°46'57" W, along said easterly line and the easterly line of that parcel annexed to the City of Lafayette by Ordinance No. 05, Series 2005 filed August 2, 2005 at Reception Number 2709635, a distance of 1345.43 feet, more or less, to an angle point in said annexation filed at Reception Number 2709635; Thence S 89°36'21" W, continuing along said easterly line and along the northerly line of said parcel annexed to the City of Lafayette Reception Number 959468, a distance of 84.84 feet to the POINT OF BEGINNING.

Containing 6.361 acres more or less.

Prepared by Joel T. Vogt  
For and on behalf of Topographic Land Surveyors  
520 Stacy Ct. Ste B, Lafayette, CO 80026

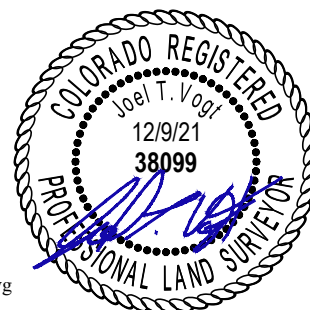

# Exhibit A

Page 2 of 2

